



Montague Area Public Schools

4882 Stanton Blvd. – Montague, MI 49437 – Telephone: 231-893-1515 – Fax: 231-894-6586

REQUEST FOR PROPOSAL Montague Area Public Schools Playground Resurfacing at the Montague Area Childhood Center

Montague Area Public Schools is seeking proposals from qualified contractors to remove and replace the current playground rubber surfacing at the Montague Area Childhood Center. The proposal should encompass (1) Removal of existing rubber safety surface (2) Installation of new poured artificial play turf system with a rubber base. The work shall commence after June 9, 2024 and shall be completed no later than August 1, 2024.

Montague Area Public Schools will accept sealed bids for playground resurfacing at the Montague Area Childhood Center. Bids will be accepted until 1:00 p.m. on March 4, 2024. No oral, telephone, E-Mail, telegraphic, or facsimile proposals will be accepted. No proposals will be accepted after the time of closing. The bid opening will take place at 1:00 p.m. on March 4, 2024 in the Central Office Conference Room located at 4882 Stanton Blvd., Montague, Michigan.

All bids must meet or exceed all the specifications contained herein. Bids must be submitted on the attached form and be signed by the bidder. Bid documents to be returned:

- One signed copy of the bid form
- One signed copy of the Familial Disclosure Statement
- One signed copy confirming compliance with the Iran Economics Sanctions Act
- Specifications associated with the project being presented in this bid

Documents can be submitted to the attention of:

Montague Area Public Schools
Stacey Brown, Director of Business Affairs
Re: Playground Resurfacing Bid
4882 Stanton Blvd.
Montague, MI 49437

Montague Area Public Schools reserves the right to reject any and all bids and to waive omissions, irregularities, or clerical errors not affecting substantial compliance with the plans and specifications. The District reserves the right to interview contractors regarding their proposals. It is anticipated that the Board will make their final approval at their March 11th Board meeting.

Any questions should be referred to Stacey Brown, Director of Business Affairs at browns@mapsk12.org no later than 3:00 p.m. on March 1, 2024. All questions and responses pertinent to this RFP will be posted on the District's website, www.mapsk12.org.

Please contact the individual below to schedule a visit to the school and to receive additional information about the project.

Tom Cederquist
Director of Operations
231-981-4606
cederquistt@mapsk12.org

BID FORM

Company Name: _____

PROJECT: Montague Area Public Schools – Playground Resurfacing at the Montague Area Childhood Center

The undersigned, having familiarized themselves with all local conditions affecting the cost of work, and having examined the sites and all applicable Bidding Documents herein, and herein referenced, including, but not limited to, all addenda issued thereto, hereby propose to furnish all labor, material, equipment, applicable taxes and services required for proper completion of the above named project for the sum of:

- 1. Playground Resurfacing: _____

SIGNATORY AUTHORITY: The undersigned certifies they are an authorized agent of the bidding entity, and legally able to bind the bidding entity to the terms, conditions and responsibilities of this, and all referenced bid documents.

Name (please print): _____

Signature: _____

Title: _____

Date: _____

Contact Information:

Phone(s): _____

Email: _____

Company Address: _____

Familial Disclosure Statement

In accordance with Section 1267 of Michigan Revised School Code this sworn and notarized statement of an authorized representative, discloses any familial relationship between the owner and/or any employee of the Bidder, and any member of the project Owner’s governing Board(s) or Superintendent(s). The law does not preclude bidders from submitting bids or a Board of Education from approving a bid with a familial relationship. The law requires the notification to allow Board members and the Superintendent to avoid recommending or voting on a conflict of interest.

The following are members of the Board for Montague Area Public Schools:

Brent Raeth **Cindy Francis** **Scott Beishuizen** **Joel Smith**
Tom Johnson **Amanda Dahl** **Karen Neubauer**

The bidder must check one of the following:

____ No, there is not a familial relationship between the Owner or any employee of the Bidder and any member of the Montague Area Public Schools Board.

____ Yes, there is a familial relationship between the Owner or an employee of the Bidder and a member of the Montague Area Public Schools Board.

	<u>Owner/Employee</u>	<u>Board Member</u>	<u>Relationship</u>
1.	_____	_____	_____
2.	_____	_____	_____
3.	_____	_____	_____
4.	_____	_____	_____

BIDDER:

Name of Company_____

Name of Representative_____

Signature_____

Date_____

NOTARY:

Subscribed and sworn this ____ day of

_____, 2024.

Notary Signature_____

Notary Public, State of _____

County of _____

My Commission expires_____

IRAN ECONOMIC SANCTIONS ACT
Michigan Public Act No. 517 of 2012

The undersigned, the owner or authorized officer of _____ (the “Bidder”), pursuant to the compliance certification requirement provided in the Montague Area Public Schools (the “School District”) Request for Proposals for Playground Resurfacing at the Montague Area Childhood Center (the “RFP”), hereby certifies, represents and warrants that the Bidder (including officers, directors and employees) is not an “Iran linked business” within the meaning of the Iran Economic Sanctions Act, Michigan Public Act No. 517 of 2012 (the “Act”), and that in the event Bidder is awarded a contract/purchase order as a result of the aforementioned RFP, the Bidder will not become an “Iran linked business” at any time during the course of performing the Work or any services under the contract.

The Bidder further acknowledges that any person who is found to have submitted a false certification is responsible for a civil penalty of not more than \$250,000.00 or 2 times the amount of the contract/purchase order or proposed contract for which false certification was made, whichever is greater, the cost of the School District’s investigation, and reasonable attorney fees, in addition to the fine. Moreover, any person who submitted a false certification shall be ineligible to bid on a request for proposal three (3) years from the date it is determined that the person has submitted the false certification.

BIDDER:

Name of Company_____

Name of Representative_____

Signature_____

Date_____

NOTARY:

Subscribed and sworn this _____day of _____, 2024.

Notary Signature_____

Notary Public, State of _____

County of _____

My Commission Expires_____

1. Summary

- a. Provide all equipment and materials for all the work necessary to complete the Playground Resurfacing Project.
- b. Project scope includes the removal of the existing poured-in-place rubber surfacing followed by the installation of a new poured artificial play turf system with a rubber base. The playground area is 2,520 square feet.
- c. The use of brand names provided in the specifications are used for the purpose of establishing a grade or quality. Products submitted in this bid should meet or exceed the specifications listed below.
- d. The playground system shall consist of
 - i. Perfect Turf® PlayGround Turf 55™ or equivalent
 - ii. A poured rubber base adequate to protect against the fall height of the play equipment and meeting the minimum specifications outlined below
 - iii. A crushed gravel support base per construction details below
- e. Contractors are highly encouraged to reach out to Tom Cederquist, Director of Operations, for a site visit. He can be reached at cederquistt@mapsk12.org.
- f. The Montague Area Childhood Center is located at 9151 Dicey Street, Montague, MI 49437.

2. Product

- a. **Perfect Turf® PlayGround Turf 55™ or equivalent**
 - i. Playground turf must meet ASTM F1951-14: Standard Specification for Determination of Accessibility of Surface Systems Under and Around Playground Equipment, and ASTM F1292-17a, Standard Specification for Impact Attenuation of Surfacing Materials within the Use Zone of Playground Equipment.
 - ii. Turf must be a complete synthetic grass system, consisting of a synthetic grass with a pile height of at least 1 1/8 inches long and not to exceed 1 3/8 inches long, 100% monofilament polyethylene fibers and polyethylene/polyester thatch layer, tufted on a 3/8" tufting machine with a minimum face weight of 55 ounces of yarn per square yard. The fibers shall include anti-static yarns, anti-microbial additives and "cool grass" reflective pigments to reduce the surface temperature. Synthetic turf products utilizing nylon blades or nylon thatch layers will not be acceptable. The system should be infilled with between 1.5 to 2.0 pounds per square foot of acrylic coated sand (commonly known as T Cool®) infill. Systems utilizing granular rubber products made of recycled tires infilled in the grass blades will not be acceptable. The system shall include a single, dimensionally stable, two-component primary backing and have a minimum of 20 ounces of secondary polyurethane backing per square yard. The finished product shall also include perforations in a 2" by 2" pattern to ensure excellent surface drainage.
- b. **Poured rubber base should meet or exceed these specifications**
 - i. Product Name
 1. Impact Attenuating Rubber Basemat (Rubber buffings with aromatic urethane)

- ii. Manufacturer
 - 1. Qualipur and Sparton Enterprises
 - 2. Approved equivalent
- iii. Product Description

BASIC USE

Rubber buffings basemat cushion layer is designed for use in playgrounds and water play areas.

COMPOSITION & MATERIALS

The basemat material consists of 100% post-consumer recycled, 3/8" shredded, SBR (styrene butadiene rubber) and high-grade aromatic polyurethane.

PRODUCT DIMENSIONS

The height of the playground equipment determines the required basemat thickness. Basemat thicknesses may vary throughout a playground site. Basemat thicknesses are determined by the "Critical Fall Height" requirements through ASTM testing. ASTM test results must be supplied showing critical fall height various thicknesses protect against.

Standard Thicknesses Available

- 2.0" – up to 4ft. CFH
- 2.75" – up to 6ft. CFH
- 3.0" – up to 7ft. CFH
- 3.5" – up to 8ft. CFH
- 4.0" – up to 10ft. CFH
- 5.0" – up to 12ft. CFH

- iv. Technical Data

APPLICABLE STANDARDS

ASTM International

- ASTM D412 Standard Test Methods for Vulcanized Rubber and Thermoplastic Rubbers and Thermoplastic Elastomers-Tension
- ASTM D624 Standard Test Methods for Tear Strength of Conventional Vulcanized Rubber and Thermoplastic Elastomers
- ASTM C1028 Standard Test Method for Determining the Static Coefficient of Friction of Ceramic Tile and Other Like Surfaces by the Horizontal Dynamometer Pull Meter Method
- ASTM D2859 Standard Test Method for Flammability of Finished Textile Floor Covering Materials
- ASTM E303 Standard Test Method for Measuring Surface Frictional Properties Using the British Pendulum Tester
- ASTM F1292 Standard Specification for Impact Attenuation of Surface Systems Under and Around Playground Equipment

ENVIRONMENTAL CONSIDERATIONS

This system makes extensive use of recycled tire rubber as a major component.

PHYSICAL/CHEMICAL PROPERTIES

- Shock Attenuation (ASTM F1292)
 - Gmax - Less than 200
 - Head Injury Criteria – 1000 or less
- Accessibility (ASTM 1951)

Straight Baseline Propulsion – 12.15

lbs Work/ft-Force

Turning Baseline Propulsion - 7.30 lbs

Work/ft-Force

- Tensile Strength (ASTM D412) - 17.51 PSI
- Tear Resistance (ASTM D624) - 6.26 lbs/force/inch
- Dry Static Coefficient of Friction (ASTM C1028) - 0.77
- Wet Static Coefficient of Friction (ASTM C1028) - .56
- Wet Skid Resistance (ASTM E303) – 51
- Flammability (ASTM D2859) – Pass
- Water Permeability (ASTM F1551-03) gal/min/yd² =363.5

Required mix proportions by weight

Basemat – 14% - 16% polyurethane, 100# rubber

v. Installation

PREPARATORY WORK

Rubber materials should be protected from exposure to harmful environmental conditions (moisture) and at a minimum temperature of 50 degrees F and a maximum temperature of 90 degrees F. Install surfacing system when minimum ambient temperature is 50 degrees F and maximum ambient temperature is 90 degrees F. Basemat may be installed in a light rain. Do not install Top Coat in any type of moisture or precipitation.

SUBSTRATE PREPARATION

1. Compacted Stone Base

Substrate must be in accordance with surfacing manufacturers Compacted Stone Base Installation Instructions before impact attenuating basemat can be applied.

2. Asphalt Substrate

New asphalt substrates must be allowed to cure for a minimum of 30 days before impact attenuating basemat can be applied.

3. Concrete Substrate

New concrete substrates must cure for a minimum of 10 days before impact attenuating basemat can be applied.

BASIC METHODS

Installation

Impact attenuating rubber basemat cannot proceed until all applicable site work, including substrate preparation, fencing, playground equipment installation and other relevant work, has been completed and approved by the safety surfacing installer.

Basemat Primer

Using a bristle brush, apply ample urethane primer to all curbing and or vertical substrates, which the rubber surfacing system will contact.

Basemat Installation

Using screed sticks and gauge poles, install the basemat rubber materials to 1/8" – 1/4" higher than required thickness. Using pool trowels, pull the basemat material together using consistent pressure throughout. Repeat the process until all areas, including use zones, comply with the architectural plans and specification requirements. Allow basemat to cure for sufficient time (24 hours) so that indentations are not left in the basemat material. Installation contractor must verify that the basemat has cured sufficiently before applying the finished topcoat

- vi. Quality Assurance
 1. Qualifications – Utilize an installer certified and trained by the manufacturer of playground surfacing system, having experience with other projects of the scope and scale of the work described in this section.
 2. Certifications – Certification by manufacturer that installer is an approved applicator of impact attenuating basemat
 3. International Play Equipment Manufacturers Association (IPEMA) Certified

c. A crushed gravel support base per construction details below

PTS Perma TURF® DETAILS

Perfect Turf® - Over Buffing Base - Playground Safety Surface Detail

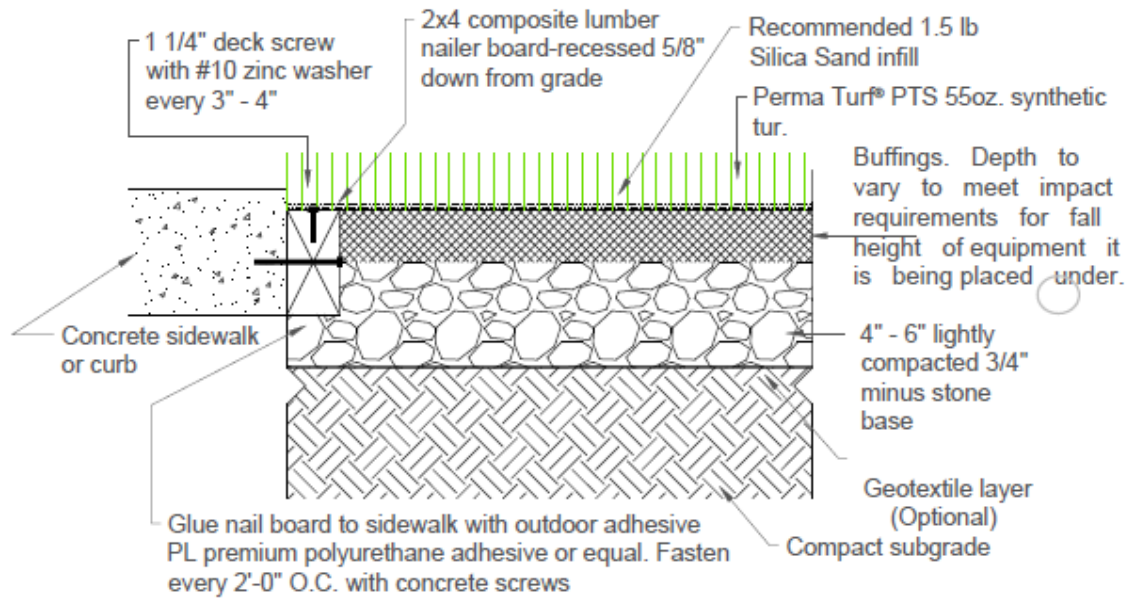

Perfect Turf Surfacing



NOT TO SCALE

L1



3. Certified Installers

- a. Installation shall be performed by Perfect Turf® (or equivalent) approved contractors.

4. Warranty Documentation

- a. Products shall have a 10-year commercial warranty
- b. Ensure warranty registration forms have been completed in District's name and registered with approved manufacturer. Provide documentation/photo copy of the warranty submittal to the District.